

# New Queen Street

## KINGSWOOD

APPROXIMATE FLOOR AREA  
79.5 SQM / 856 SQFT



GROUND FLOOR

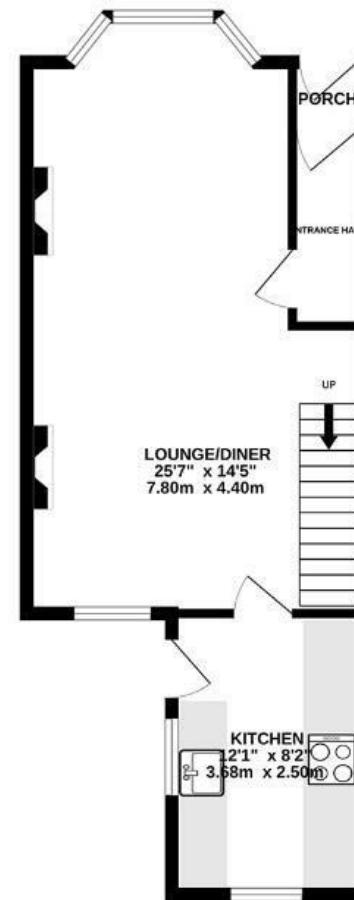

FIRST FLOOR



Illustrations are for reference purposes only, measurements are approximate, not to scale.

Boardwalk

# New Queen

KINGSWOOD, BRISTOL

£

£300,000



BS15 1DE

zzz

2 Bedrooms



1 Bathrooms

*"We fell in love with the spacious open plan living area when we first saw our house on New Queen Street. We've made lots of memories here as it's perfect for hosting friends. In the Spring and Summer the patio area is a sun trap, ideal for lazy afternoons reading a book. We have easy access to St George's Park and Redfield, as well as Kingswood high street. We spend lots of time walking at Magpie Bottom nature reserve, less than 10 minutes from our door and it's so peaceful."*

